

DATE:	COMMENTS:
PROJECT:	



FEATURES

- Premium long-life, high-temperature fused nickel cadmium battery with standard UL listed 3-hour run time
- Battery diagnostic system standard – battery status: detects cell failure and issues alert of reduced capacity and the need to replace battery
- Line-latch prevents unnecessary discharge of battery during installation. Loads will not illuminate until after application of utility power
- Specialty finish upon request
- Low profile recessed housing is suitable for old or new work installations and is Type IC Rated
- Brownout detection ensures emergency operation during periods of low line voltage
- Sealed external momentary test switch and dual diagnostic LED indicator displays AC presence and Hi-Charge status
- Self-Test / Self-Diagnostic monitoring available
- Zero current low-voltage disconnect
- Slimline, low profile surface mount housing eliminates need for recessed box in wall mount applications
- Unique electronic driver circuit provides current control and protection, ensuring optimum LED efficiency and life
- 120/277 VAC field-selectable inputs (with the exception of the dual-circuit option which requires voltage specification upon ordering)

ORDERING INFORMATION *ELTCG-AC-G-1C-AG-BA-MB*

1. SERIES	2. OPERATION	3. LETTER COLOR	4. FACE COUNT	5. FRAME STYLE	6. FRAME COLOR
ELTCG	-	-	-	-	-
	AC AC Only EM Ni-Cad Battery Backup	G Green R Red WH White BL Blue	1C Single Face, Clear Background 1M Single Face, Mirror Background 1W Single Face, White Background 2M Double Face, Mirror Background 2W Double Face, White Background	AG Angular Trim FT Flat Trim ¹ <small>1. Only available with recessed mount.</small>	BA Brushed Aluminum BK Black CC Custom Color WH White BR Painted Brass

7. MOUNTING

MRCLB Recessed Ceiling Mount ²	MMR Mullion Mount (Rear)
MB Back Mount	MMT Mullion Mount (Top)
ME End Mount / Side Mount	MPA 12" Pendant Mount
MRC Recessed Ceiling Mount	MPB 24" Pendant Mount
MT Top Mount	MPC 36" Pendant Mount
MMB Mullion Mount (Bottom)	MPD 48" Pendant Mount

8. OPTIONS

BLANK = NO OPTION	FA Fire Alarm Interface
C1 Dual Circuit (120 VAC) (AC Only)	FAA FA Option w/Audible Alarm
C2 Dual Circuit (277 VAC) (AC Only)	FL Flasher
SD Self-Diagnostics (EM Only)	FLA Flasher / Audible Alarm
SR Self-Diagnostics + IR Remote Testing Receiver (EM Only)	LD Damp Location
VF Other Input Voltage (Indicate Volt & Frequency)	

ORDERING NOTES

1. Flat Trim only compatible with MRC mounting option
2. Preship Backbox (See Accessories on Back for Backbox)

ACCESSORIES ON BACK

ACCESSORIES; ORDER SEPARATELY

- ELT-ACCY-RBB = Recessed Backbox for ELT
- TLRT = Handheld Remote Control Test Unit, used with SR option
- WG 1 = Wire guard 17.0" X 17.0" X 17.0"
- WG 10 = Wire guard 13.5" X 12.0" X 16.5"

CONSTRUCTION

- "Snap-in Lens" for easy installation.
- Recessed back box can be pre-installed at job site
- Precision die-cast aluminum housing with a flawless, laser-formed acrylic legend
- Hinged springs allow for concealed mounting hardware on recessed models
- Recessed back box meets New York specifications

INPUT POWER

- AC models: Red 1.5W; Green 2.3W
- EM models: Red 2.5W; Green 3.0W

WEIGHT

- Surface Wall/Ceiling/End/Mullion Mount: 9 lbs
- Recessed Ceiling: 8 lbs
- Back Box: 4 lbs

APPROVALS

- UL 924
- CEC Title 20 Compliant
- NFPA 70- NEC
- OSHA
- Recessed backbox is IC rated and meets New York specifications

TEMPERATURE RATING

- From 32°F to 102°F

WARRANTY

- Isolite offers a 5-year limited warranty. For further details, refer to General Warranty and Obligations in the Isolite manual or on our website

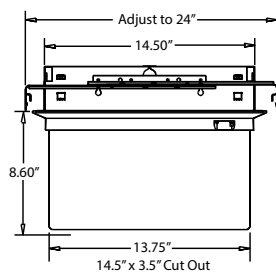
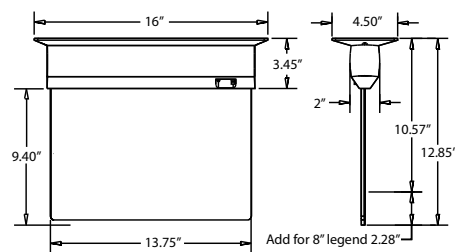
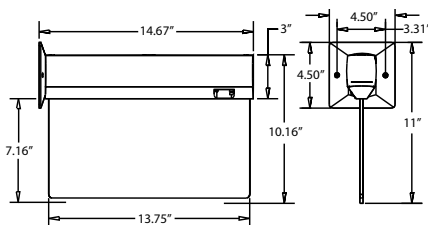
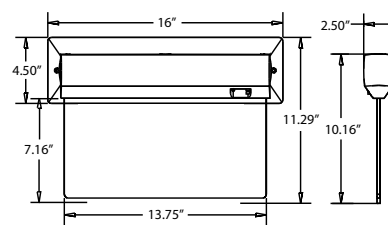
DIMENSIONS

RECESSED CEILING MOUNT

TOP MOUNT

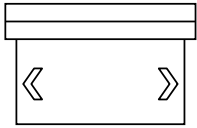
END/SIDE MOUNT

BACK MOUNT

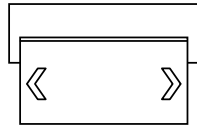
CHEVRON DECODER

1) MOUNTING CONFIGURATION



Ceiling Mount
(Recessed or Surface)



Wall Mount
(Surface Only)

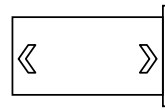

End Mount Right
(Surface Only)

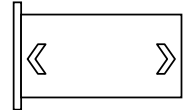

End Mount Left
(Surface Only)

2) CHEVRON DIRECTION



No Chevron (NA)

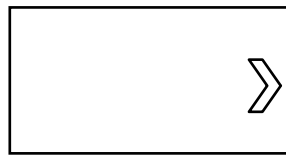

Right Chevron (AR)



Left Chevron (AL)



Double Chevron (AB)

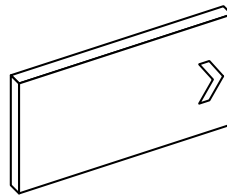

SIDE A



SIDE B

Left & Right Chevron (AS)
(Double Face Only)

PANEL FIELD REPLACEMENT

In some instances, the ELT panels can be replaced in the field. The single face clear panel replacements must be performed in an Isolite manufacturing facility. For more information please call Isolite customer service.

		DESIRED CHANGE				
		1C	1M	1W	2M	2W
EXISTING SIGN	1C		No	No	No	No
	1M	No		Yes	Yes	Yes
	1W	No	Yes		Yes	Yes
	2M	No	Yes	Yes		Yes
	2W	No	Yes	Yes	Yes	